

Edward Jones ES-BOA-LH-INS assembly

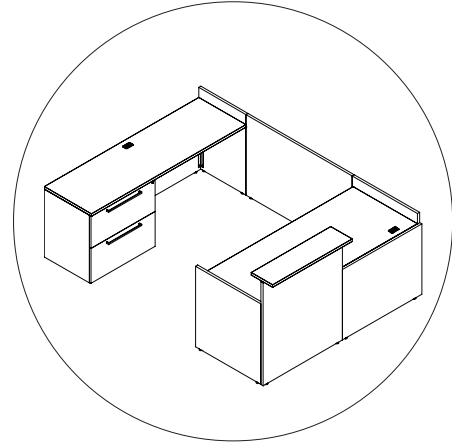



ES-BOA-LH-INS reception assembly

Before installation, make sure you have the right amount of cartons of furniture

Install transaction shelves **Note:** Main desk will already be built.

1. If connecting a return to reception, remove post by sliding it upward (**Figure A/Detail A**). If not go to step 2.

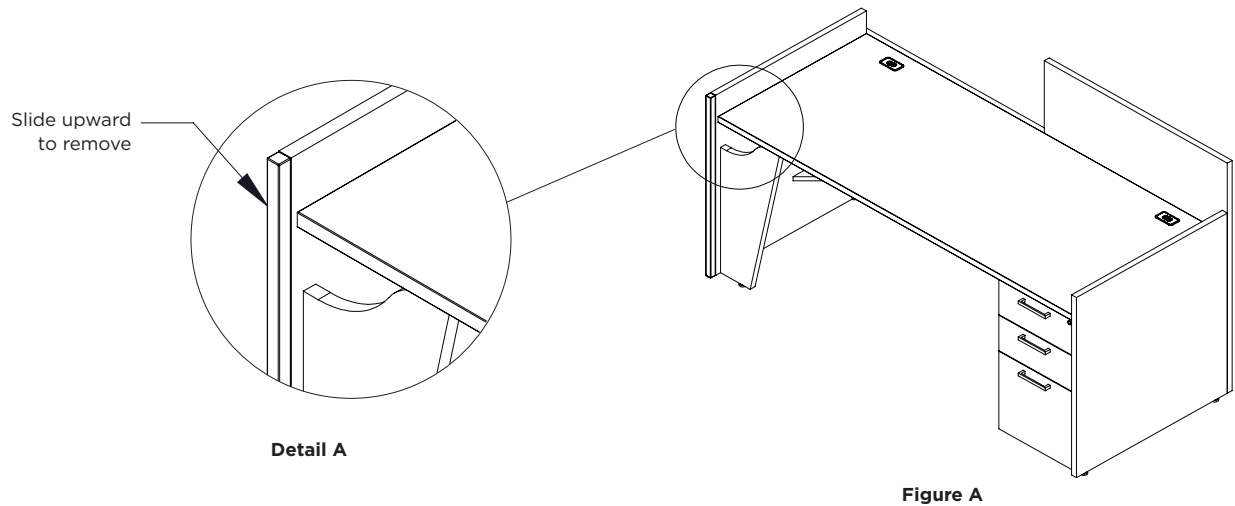

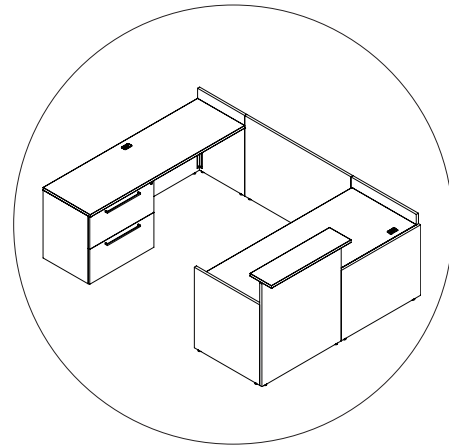

2. Make sure the head of the bolt for the transaction shelf bracket is facing towards the worksurface side of the wall panel. This will be the same side that has screws already in the bracket. **(Figure B/Detail B)**
3. Place transaction shelf on top of the wall panel till there's about a .5" gap between the underside of transaction top and top of wall panel. **(Figure C)**
4. Tighten bolt on transaction bracket until the front part of the bracket is tight against the wall panel.
5. Once the bracket is tightened on the wall panel, screw the front part of the bracket to the underside of the transaction shelf **(Figure D)**.

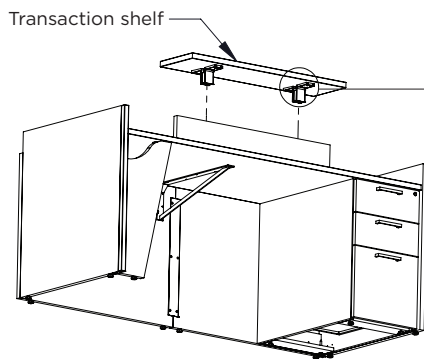
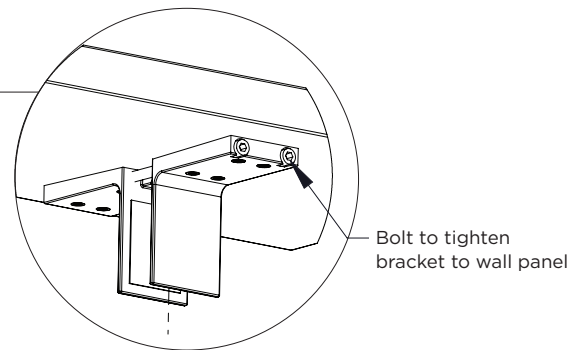

Figure B



Detail B

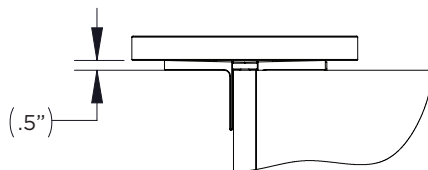

Figure C

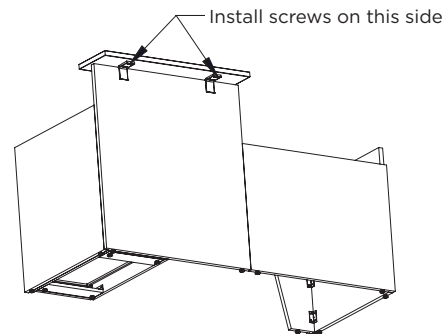
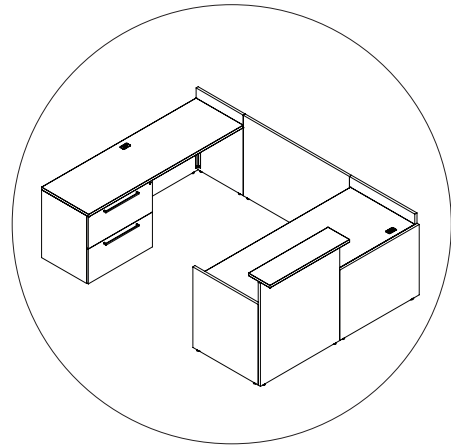

Figure D



Before installation, make sure you have the right amount of cartons of furniture

Part 2: Install additional panels

1. Make sure all hardware is installed into the routes of the wall panels. **(Figure E)**
2. Make sure the main reception desk is leveled.
3. When installing a wall panel, it has to be raised higher than the static wall panel so that the bolt can slide into the groove of the clip of the other panel. **(Detail E)**
4. Top edge of all the wall panels should be flush and even, adjust leveler if necessary. The seam between each wall panel should be tight. Adjustment to the bolt may have to be done to make the seam tighter or looser.

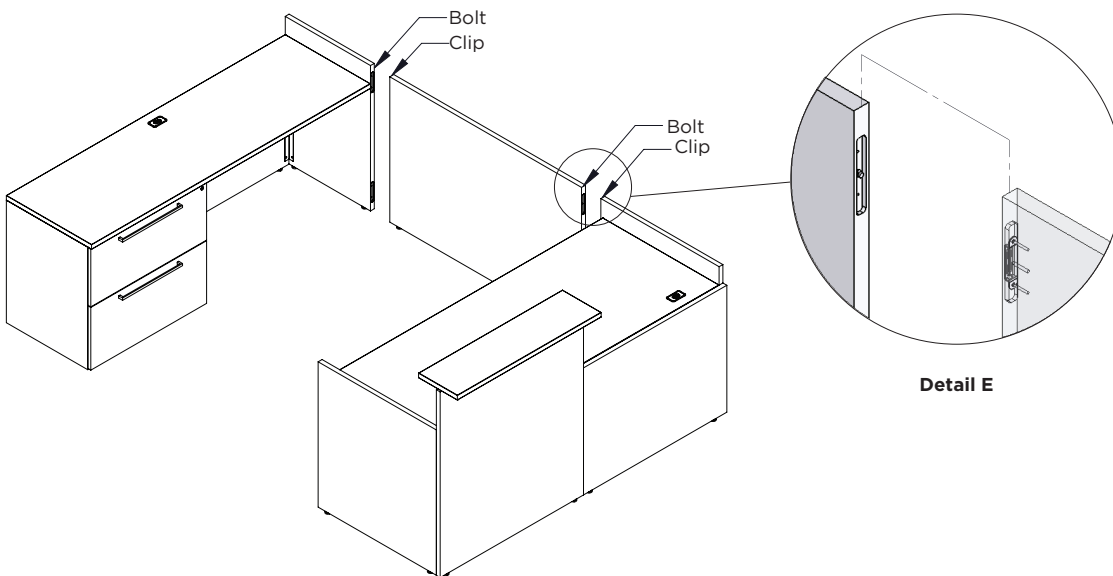

Figure E